

ing Commission
igh St.
97303



FP 79-2

13 1980

ELEVATION/FLOODPROOFING CERTIFICATION FORM *
(For Use In Zones A1-30, and V1-30)

8136 Marion Rd
Turner P135
FP 79-2

The appropriate section of this form must be completed for:

- (1) Any structure for which construction or substantial improvement was started after the date the community entered the Regular Program or,
- (2) Any structure existing prior to the date the community entered the Regular Program for which actual rating dependent on the structure's elevation relative to the base flood is desired.

The floodproofing and elevation sections of this form must be completed by either a registered professional engineer or architect. The elevation section may also be completed by a licensed land surveyor.

NOTE: The elevation certification may be replaced by an equivalent form from the local permit official.

I certify that the structure at the property location described below is constructed so that the lowest floor is at an elevation of 297.2 feet NGVD (mean sea level).

I certify that the structure, together with the proposed utility and sanitary facilities, are designed so that the structure will be watertight to an elevation of _____ feet NGVD (mean sea level), with walls substantially impermeable to the passage of water and structural components having the capability of resisting hydrostatic and hydrodynamic loads and effects of bouyancy.

My certification is conditional upon the actual construction of the building in strict accordance with the plans presented to me.

In the event of flooding, will this degree of floodproofing be achieved with human intervention**?
Will the structure be occupied as a residence? _____

**Floodproofed with human intervention means that water will enter the structure when floods up to the base flood level occur, unless measures are taken prior to the flood to prevent entry of water (e.g., bolting metal shields over doors and windows).

Affix Seal Here:

Signature Ronald H. Schulson
 Name and Title Ronald H. Schulson L.S.
 Address P.O. Box 418
 Date 2-11-80
 *Not Required: Suggested Only

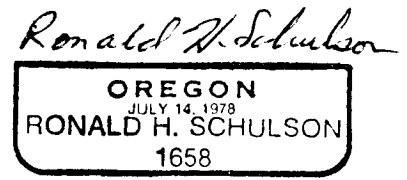
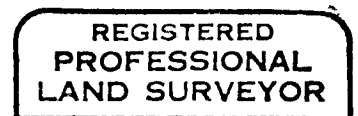

Subscribed and sworn to before me this 12th day of February, 1980.
Jacob McKamey subscribed his signature hereto this 12th day of February, 1980.

Ronald H. Schulson
Notary Public for Oregon.
My commission expires: 5-24-80

ELEVATION / FLOODPROOFING CERTIFICATION

FP 86-22

INSTRUCTIONS: As a condition of approval for a Flood Plain Development Permit a certification of structure elevation or floodproofing may be required (Section 178.060 of the Marion County Zoning Ordinance). Section 1 of this form is for the purpose of certifying that a structure has been constructed so that the lowest floor is at an elevation of one (1) or more feet above the 100 year flood level. The certification must be completed by a registered land surveyor or civil engineer.

Section 2 is used to certify that a structure has been adequately floodproofed. It must be completed by a registered civil/structural engineer.

Please complete the applicable section and certification and return the completed form to the County Planning Department at 220 High Street NE, Salem, Oregon.

SECTION 1

I certify that the structure located at (address) 8135 Marion Road, Turner, OR
97392 is constructed so that the lowest floor
is at an elevation of 296.94 feet NGVD (mean sea level).

SECTION 2

I certify that the structure located at (address) _____
_____, together with the proposed utility and
sanitary facilities, are designed so that the structure will be watertight to an
elevation of _____ feet NGVD (mean sea level), with walls substantially
impermeable to the passage of water and structural components having the compati-
capability of resisting hydrostatic and hydrodynamic loads and effects of
bouyancy.

My certification is conditional upon the actual construction of the building in
strict accordance with the plans presented to me.

In the event of flooding, will this degree of floodproofing be achieved with
human intervention? _____ (see Note)

Will the structure be occupied as a residence? _____

NOTE: Floodproofed with human intervention means that water will enter the
structure when floods up to the base flood level occur, unless measures
are taken prior to the flood to prevent entry of water (e.g., bolting
metal shields over doors and windows).

Affix seal here:



Name Robert P. Gorman
(print or type)
Address 349 S. W. Division St., Sublimity, OR
Signature Robert P. Gorman
Date Feb. 5, 1987

Case No. _____