

ELEVATION / FLOODPROOFING CERTIFICATION

FP 89-1

INSTRUCTIONS: As a condition of approval for a Flood Plain Development Permit a certification of structure elevation or floodproofing may be required (Section 178.060 of the Marion County Zoning Ordinance). Section 1 of this form is for the purpose of certifying that a structure has been constructed so that the lowest floor is at an elevation of one (1) or more feet above the 100 year flood level. The certification must be completed by a registered land surveyor or civil engineer.

Section 2 is used to certify that a structure has been adequately floodproofed. It must be completed by a registered civil/structural engineer.

Please complete the applicable section and certification and return the completed form to the County Planning Department at 220 High Street NE, Salem, Oregon.

SECTION 1

I certify that the structure located at (address) 24095 Butteville Rd
Butteville, OR. is constructed so that the lowest floor
is at an elevation of 109.5 feet NGVD (mean sea level).

SECTION 2

I certify that the structure located at (address) _____
_____, together with the proposed utility and
sanitary facilities, are designed so that the structure will be watertight to an
elevation of _____ feet NGVD (mean sea level), with walls substantially
impermeable to the passage of water and structural components having the compati-
capability of resisting hydrostatic and hydrodynamic loads and effects of
bouyancy.

My certification is conditional upon the actual construction of the building in
strict accordance with the plans presented to me.

In the event of flooding, will this degree of floodproofing be achieved with
human intervention? _____ (see Note)

Will the structure be occupied as a residence? _____

NOTE: Floodproofed with human intervention means that water will enter the
structure when floods up to the base flood level occur, unless measures
are taken prior to the flood to prevent entry of water (e.g., bolting
metal shields over doors and windows).

Affix seal here:

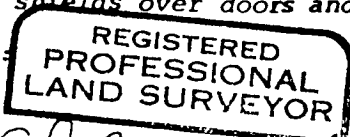

Name CHARLES H. HAYLOCK
PACIFIC SURVEYS
(print or type)

Address PO BOX 766 CANBY, OR. 97013

Signature Charles H. Haylock

Case No. _____