

check your ballot!

Make sure you have fully completed the arrows next to your choices.

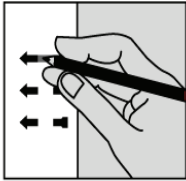

If you vote for more candidates than allowed, or if you vote **both** Yes **and** No on a measure, it is called an overvote.

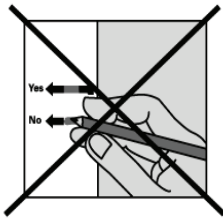
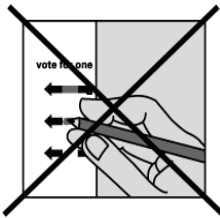

Your vote **will not count** for that candidate or measure.

You do not have to vote for everything on the ballot. The contests you do vote on will still count.

Contact Marion County Elections to request a replacement ballot if:

- you make a mistake that cannot be corrected
- your ballot is damaged or spoiled or for any other reason.

503.588.5041 or 1.800.655.5388

<http://www.co.marion.or.us/CO/elections/>

503.588.5610 (TTY/TDD)



OREGON MARION COUNTY VOTER PAMPHLET

November 6, 2007
Special Election

Bill Burgess
Marion County Clerk

CITY OF ST. PAUL

4263 Commercial St SE, #300, Salem
Phone: 503-588-5041 or 1-800-655-5388
TTY/TDD: 503-588-5610 FAX: 503-588-5383

E-Mail: elections@co.marion.or.us
Website: <http://www.co.marion.or.us/CO/elections/>

If you have a disability or are otherwise unable to mark your ballot, you may contact the Elections Office for assistance.

Ballots for Marion County voters will only be issued from the County Elections Office, 4263 Commercial St. SE, Room 300, Salem.

Marion County Ballot Drop Sites are open normal business hours beginning on October 22, 2007 and until 8:00 PM on Election Day, November 6, 2007.

Please see the other side of this Voter Pamphlet to view the drop site loca-

A Complete listing of Marion County Ballot Drop Site Locations listed inside.

REGISTRATION INFORMATION

- **New registrations** needed to be completed and post-marked by October 16, 2007.

If you have questions about registration or voting, contact the Elections Office.

IMPORTANT BALLOT INFORMATION

If a ballot has been delivered to your address and it is addressed to **someone who does not live at your address**:

1. Mark through the address like this:
2. Return to your mailbox, post office or letter carrier.

If a ballot has been delivered to someone at your address **who is deceased**:

1. Mark through the address like this:
2. Write "Deceased" on the envelope.
3. Return to your mailbox, post office or letter carrier.

Notify Marion County Elections **BEFORE** voting the ballot delivered to you if:

- Your name is different than that on the label; or
- Your residence address has changed; or
- You have added, deleted or changed a mailing address.

REVIEW THE BALLOT PACKET

It should contain the following additional items:

- Printed ballot
- Secrecy envelope
- A brown pre-addressed return envelope

If any items are missing, contact Marion County Elections.

INSTRUCTIONS FOR VOTING YOUR BALLOT

To make sure your vote counts:

- **DO NOT** use a felt tip pen to mark your ballot. Use a pencil or black ballpoint ink pen.
- Mark the arrow with a single line. Do not make multiple/ heavy marks. Vote the ballot on a hard surface.
- To vote on a measure, complete the arrow pointing to either the "YES" or "NO",

LIKE THIS

NOT THIS: OR THIS:

CHECK YOUR BALLOT

- Make sure you have completely filled in the arrow(s) next to your choice(s).
- If you vote **both YES and NO** on a measure, it is called an Overvote. Your vote will not count for that measure.
- You do not have to vote on all contests. Those you do vote on will still count.

RETURNING YOUR VOTED BALLOT

- Place the ballot in the secrecy envelope, seal it, then place the secrecy envelope in the brown return envelope. Do not remove the label.
- Sign the Voter Statement on the back of the brown return envelope. Your ballot will not be counted if you do not sign your envelope.
- To return your ballot by mail, place one first class stamp on the envelope.
- To return your ballot other than through the mail, you may refer to the list of ballot drop sites. You may return your ballot to any Official Ballot Drop Site in

FOR YOUR BALLOT TO BE COUNTED

- Mark your ballot according to voting instructions.
- Do **NOT** remove any label(s)
- Use your secrecy envelope.
- Your brown return ballot envelope **must be signed**.
- Your ballot must be received in the Elections Office or an Official Ballot Drop Site by 8:00 p.m. on Election Day. **POSTMARK DOES NOT COUNT.**

WHAT IF I . . . ?

What if I make a mistake on my ballot?

If you make a mistake that cannot be corrected, call the Marion County Elections Office and request a replacement ballot. One will be mailed to you provided the request is received within time for mailing. Otherwise, you may pick up a replacement ballot in person.

What if I change my mind after I turn in my ballot?

Your ballot has been cast as soon as you deposit it in the mail or at a drop site. After that, you cannot receive a new ballot.

What if I don't vote on everything on the ballot?

Your ballot will be counted.

What if I don't sign my return envelope?

Your ballot will be returned to you for your signature, unless there isn't time to return it by mail. In that case, you will need to come into our office and sign it.

CITY OF ST. PAUL

Referred to the People by the City Council

24-243 FIVE-YEAR LOCAL OPTION TAX FOR CITY OPERATIONS

QUESTION: Shall the City of St. Paul propose \$1.50 per \$1,000 assessed value each year for five years for operations beginning 2008-09? This may cause property taxes to increase more than three percent.

SUMMARY: This measure may be passed only at an election with at least a 50 percent voter turnout. The City of St. Paul is faced with a variety of expenditures including land use planning, housing development, and resource protection. At the present time two part-time employees, consultant assistance, and volunteer citizens efforts are addressing these issues.

The City's permanent tax rate raises approximately \$16,172 per year. For the average homeowner in the City with a home assessed at \$150,000 the annual taxes collected are \$92.35. These funds are deposited into the general fund to cover expenditures such as; street lighting, police protection, land use planning, housing development, resource protection, budget and financial management, insurance, general administration, professional services; auditing, legal consultation, engineering, and planning.

Measure 24-243 proposes a five year local option tax; passage of this measure would result in an increase in property taxes of \$1.50 per year per \$1,000 assessed value. For the average homeowner in the City with a home assessed at \$150,000, the annual property tax increase would be approximately \$225 annually. The proposed rate would raise approximately \$39,398 in fiscal year 2008-09 for city operations.

EXPLANATORY STATEMENT

What does the measure propose?

This five (5) year local option tax would continue a current tax of \$1.50 per \$1,000 assessed value which expired June 30, 2007. This local option tax would be in addition to the City's permanent tax rate of \$0.6157. This tax revenue would go into the city's General Fund.

What is the General Fund?

The General Fund pays for most city expenditures not covered by the city's sewer, water, and street revenues which are dedicated funds. The General Fund covers such services as street lighting, police, land-use planning, housing development, budget and financial management, record keeping, insurance, administration, and professional services for auditing, legal, engineering and planning.

EXPLANATORY STATEMENT (continue):

Why is this additional General Fund Revenue for St. Paul proposed?

The City currently gets funding from a permanent tax rate of \$0.6157 and temporary local option tax of \$1.50 to supplement the General Fund. The temporary tax expired on June 30, 2007. Without additional tax revenue, the City must rely on the permanent tax rate to support services. Based on 2007/08 budget information, tax revenue collected for General Fund purposes will be reduced to approximately \$16,172 unless another local option tax is approved by the voters.

The City is legally required to carry out General Fund functions relating to a variety of issues such as land-use planning, and development, budgeting and record keeping. These issues are currently being addressed with two part-time employees, limited consultant assistance, and citizen volunteer contributions. The local option tax is being proposed to maintain the current level of City services for five more years.

How much tax revenue does St. Paul currently collect?

The current property tax rate for the City of St. Paul is a combination of three separate taxes (permanent, local option, and sewer bond) totaling approximately \$2.59 per \$1,000 of assessed value. If voters approve the proposed local option tax, the City's combined tax rate would continue at approximately this rate from July 15, 2008 to June 30, 2012.

What should citizens know about the requested local option tax?

Under state law, the City cannot increase its permanent tax rate. It may ask voters to approve temporary tax measures. The revenues from the measure must be put into a separate fund and can only be used for the purpose stated in the measure. If this measure is approved, the City would collect the first year's revenue beginning in fiscal year 2008-09. If the local option tax is not approved, the City would only collect taxes at the permanent tax rate of \$0.6157 per \$1,000 of assessed value starting November 15, 2007.

The impact of the proposed levy on an individual homeowner would vary by the value of the home. At the proposed combined rate of \$2.59, property taxes on a \$150,000 home would be \$388.50 per year.

Submitted by:
Lorrie Biggs, City Recorder
City of St. Paul

OFFICIAL MARION COUNTY DROP SITES

Notice:

The outside Drive-thru ballot drop site has **MOVED** from the Elections Office on South Commercial St.

The **NEW**, centrally located, Drive-thru is located in the 500 Block of Court St., on the north side of the **Marion County Courthouse**.

**Open: Monday, Nov. 5th and Tuesday, Nov. 6th
6:00 AM - 8:00 PM**

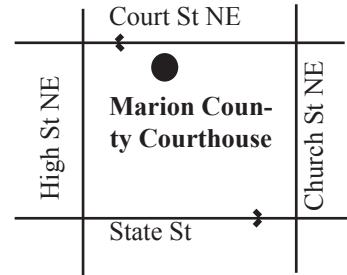

All Marion County Drop Sites are open normal business hours beginning on October 22nd and will remain open Election Day, November 6, 2007 until 8:00 PM.

South & East

New
DMV, Sunnyslope Shopping Cntr.
4555 Liberty Rd S. Suite 300, Salem

Marion County Elections
** Inside Service Only*
4263 Commercial St. SE, Room 300, Salem

Aumsville City Hall
595 Main Street, Aumsville

Jefferson Fire Department
189 N. Main St, Jefferson

Stayton Public Library
515 N. First St., Stayton

Sublimity City Hall
245 NW Johnson, Sublimity

Turner City Hall
7250 3rd St, Turner

U.S. Bank
400 N. Santiam Blvd, Mill City

Central & North

Marion County Courthouse
100 High St NE, Salem, Lobby

Marion County Extension
3180 Center St NE, Rm 1361, Salem

Marion County Public Works
5155 Silverton Road NE, Salem

Donald City Hall
10710 Main St NE, Donald

Gervais City Hall
524 4th St, Gervais

Hubbard City Hall
3720 2nd St, Hubbard

Keizer City Hall
930 Chemawa Rd NE, Keizer

Silverton City Hall
306 S. Water St, Silverton

St. Mary's Public School
590 E. College St., Mt. Angel

Woodburn City Hall
270 Montgomery St, Woodburn

BALLOTS FOR MARION COUNTY VOTERS WILL ONLY BE ISSUED FROM THE COUNTY ELECTIONS OFFICE, 4263 COMMERCIAL STREET SE, ROOM 300, SALEM