

2018 Willamette Country Music Festival

Traffic Plan Overview

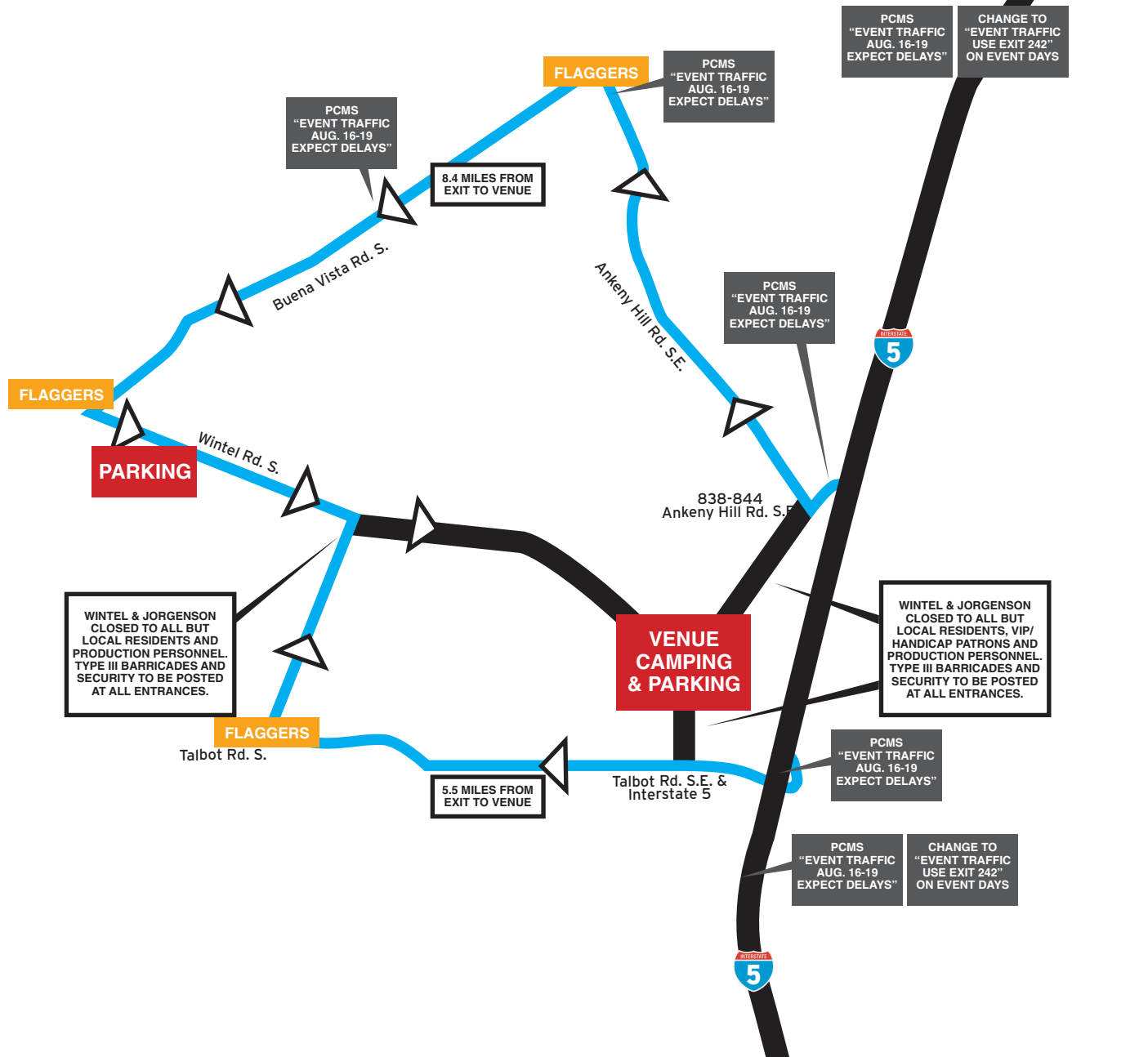

PCMS Note

All PCMS to be placed 10 days prior to event date with the I-5 messages being changed as shown on the date of the event. I-5 PCMS to be placed approximately 2 miles North/South of respective exit ramps. Specific locations shall be agreed upon by ODOT, County and other appropriate authorities based on sight distance, visibility, safety, etc.

Emergency Vehicles

One lane of traffic shall always remain open at all times for emergency vehicles.

Certified Flaggers

to be posted at intersections shown. See individual sheets for TCP setup. Flaggers and security will also be used at individual parking entrances/exits based on need and actual location. Note that traffic exiting can be forced any direction—including through the closed roads of Wintel and/or Jorgenson—to keep exiting traffic flowing continuously.

All Traffic Control

shall conform to the standards set forth in the MUTCD and the Oregon Temporary Traffic Control Handbook.

2018 Willamette Country Music Festival

Jorgenson and Talbot Intersection

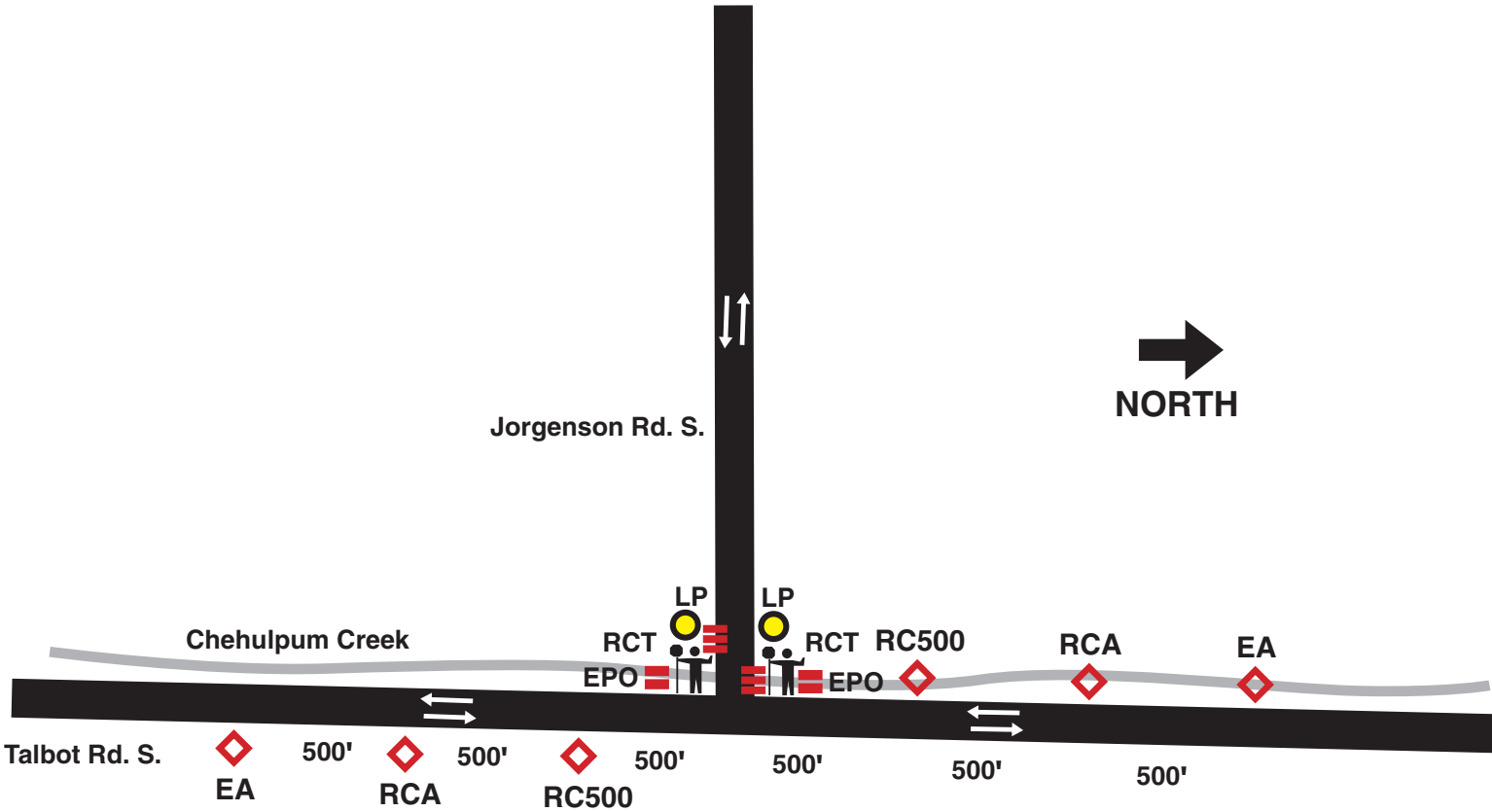

This location will be tended at all times, by one or two people– depending on the need– and may be removed completely at times if traffic flow dictates it, such as the end-of-night outflow traffic.

Illumination will be provided at night, although the intent is to let the signs guide traffic and not to actually “flag” at this location.

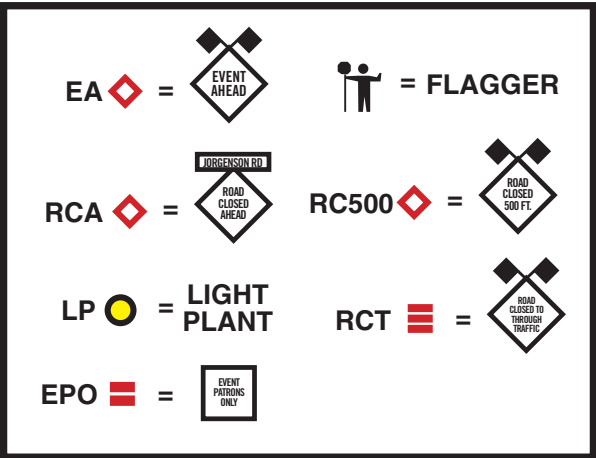

SIGN AND EQUIPMENT COUNT
Sign Spacing- 500'/ Sign Size- 36"

Event Ahead (EA)	2
Road Closed Ahead (RCA) with Jorgenson Rd. rider above	2
Road Closed-500' (RC500)	2
Road Closed To Through Traffic (RCT) Type III Barricade/ Staggered	2
Event Patrons Only (EPO) Type II Barricade	2
Light Plants	2

2018 Willamette Country Music Festival

Ankeny and Wintel Intersection

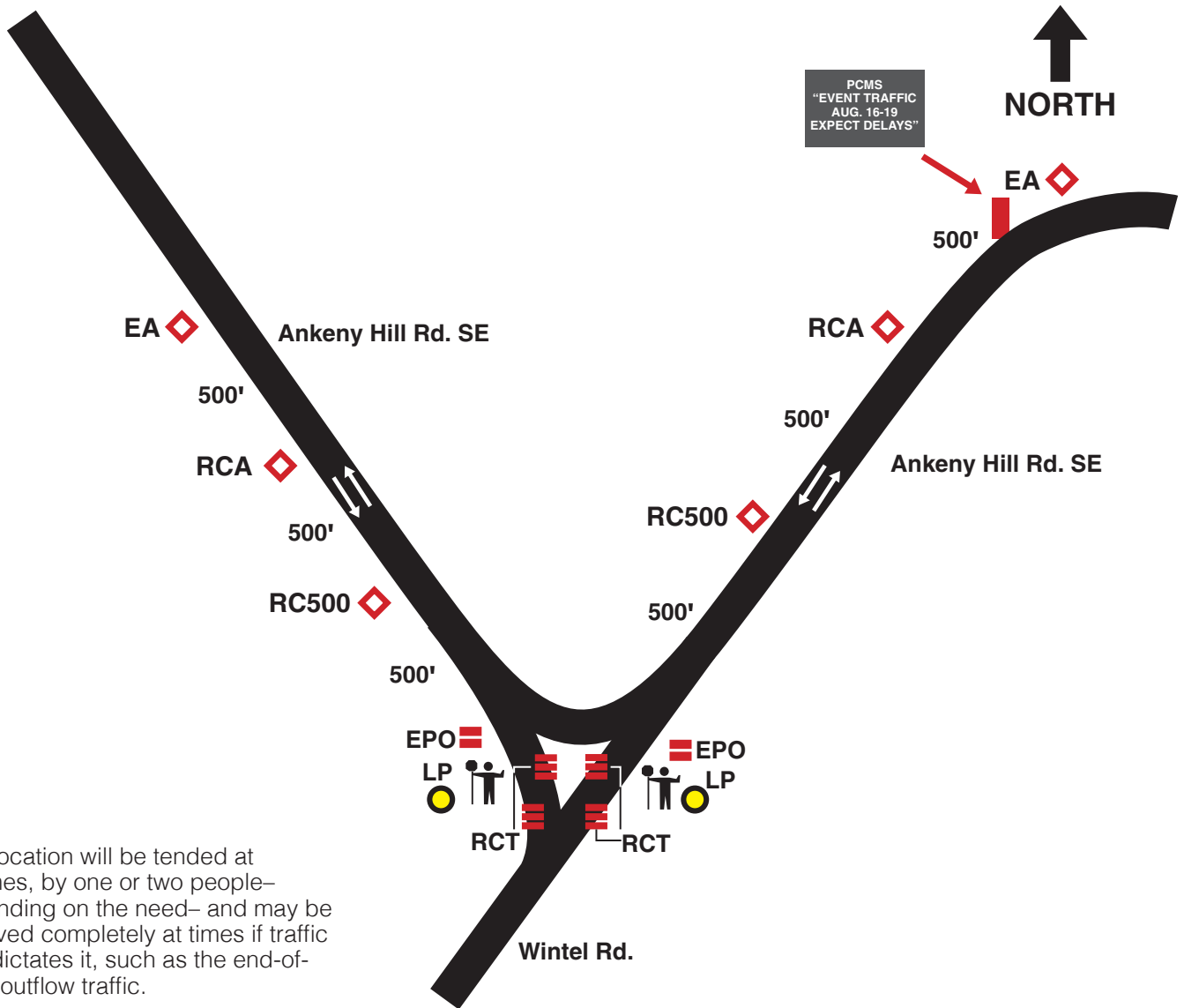

This location will be tended at all times, by one or two people—depending on the need— and may be removed completely at times if traffic flow dictates it, such as the end-of-night outflow traffic.

Illumination will be provided at night, although the intent is to let the signs guide traffic and not to actually “flag” at this location.

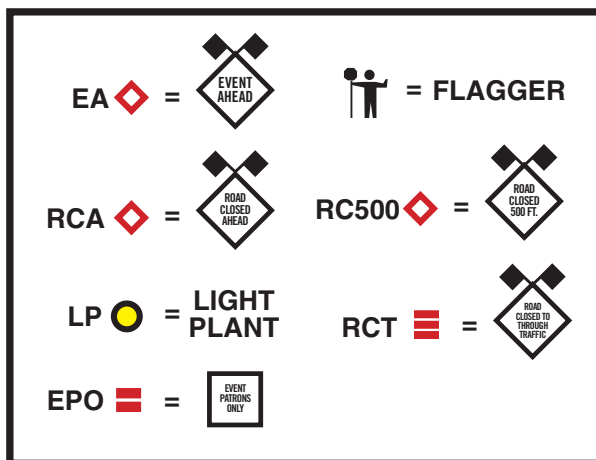

SIGN AND EQUIPMENT COUNT

Sign Spacing- 500' / Sign Size- 36"

Event Ahead (EA)	2
Road Closed Ahead (RCA)	2
Road Closed-500' (RC500)	2
Road Closed To Through Traffic (RCT) Type III Barricade/ Staggered	4
Event Patrons Only (EPO) Type II Barricade	2
PCMS	1
Light Plants	2

2018 Willamette Country Music Festival

Buena Vista Rd. and Ankeny Hill Intersection

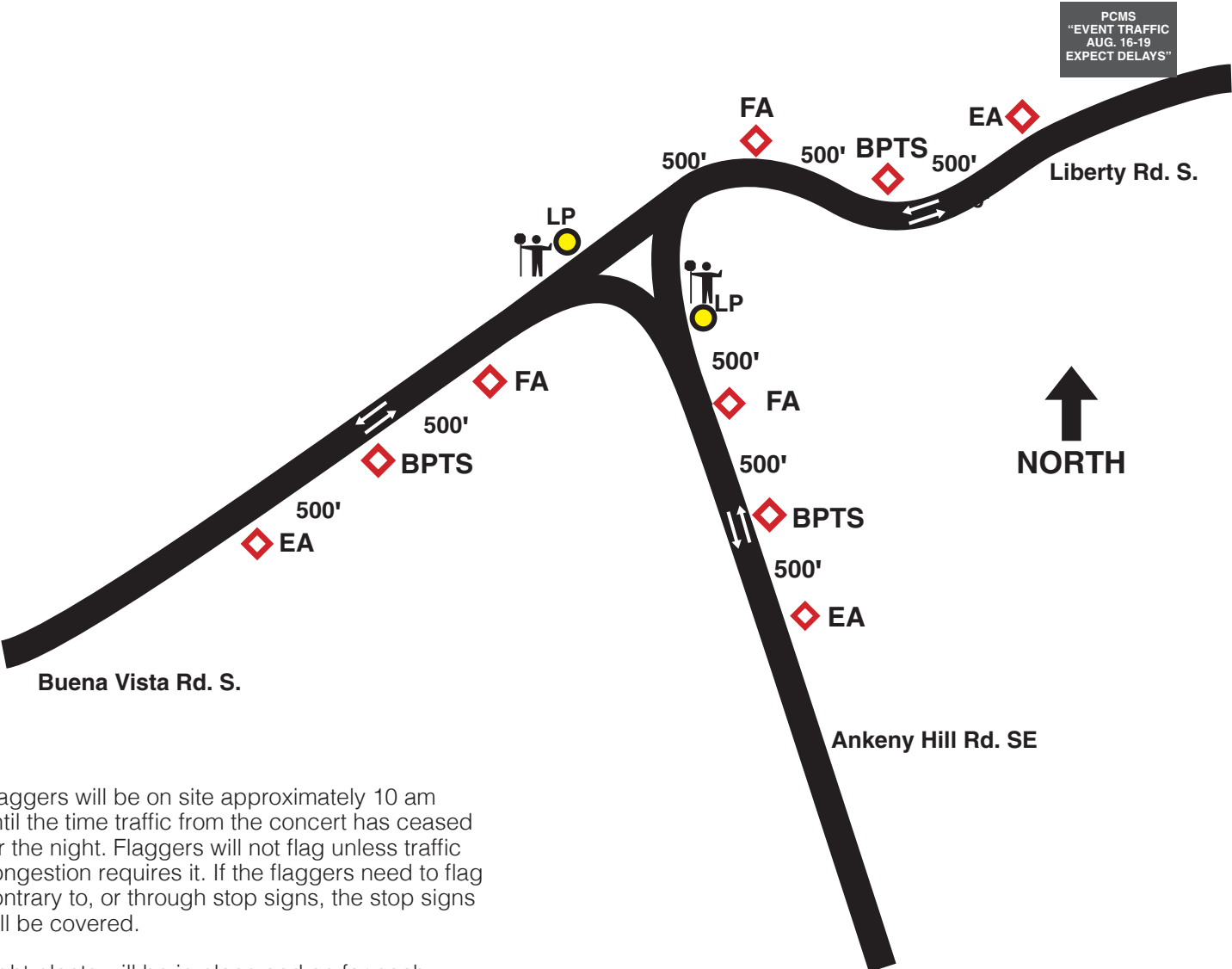

Flaggers will be on site approximately 10 am until the time traffic from the concert has ceased for the night. Flaggers will not flag unless traffic congestion requires it. If the flaggers need to flag contrary to, or through stop signs, the stop signs will be covered.

Light plants will be in place and on for each flagger. All times will be reviewed daily and changed accordingly.

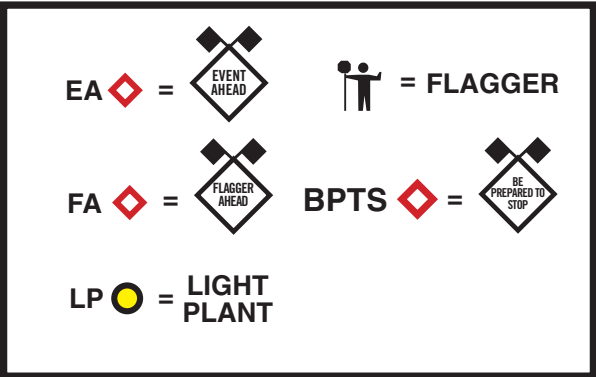

SIGN AND EQUIPMENT COUNT
Sign Spacing- 500'/ Sign Size- 36"

Event Ahead (EA)	3
Be Prepared to Stop (BPTS)	3
Flagger Ahead (FA)	3
PCMS	1
Light Plants	2

2018 Willamette Country Music Festival

Buena Vista Rd. and Wintel Intersection

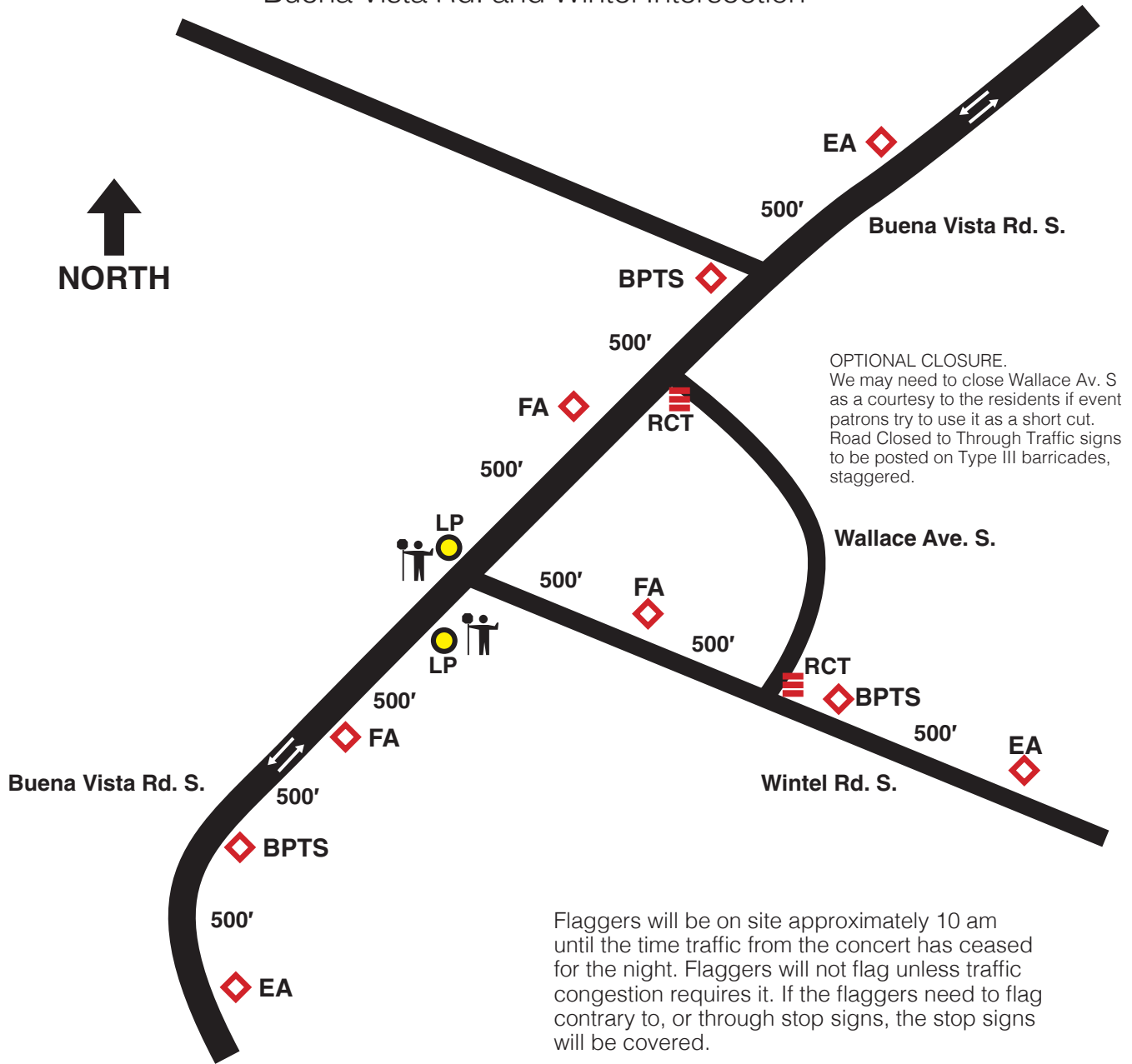

Flaggers will be on site approximately 10 am until the time traffic from the concert has ceased for the night. Flaggers will not flag unless traffic congestion requires it. If the flaggers need to flag contrary to, or through stop signs, the stop signs will be covered.

Light plants will be in place and on for each flagger. All times will be reviewed daily and changed accordingly.

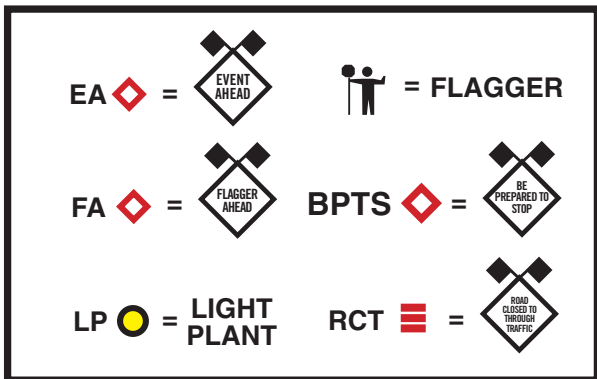

SIGN AND EQUIPMENT COUNT Sign Spacing- 500'/ Sign Size- 36"

Event Ahead (EA)	3
Be Prepared to Stop (BPTS)	3
Flagger Ahead (FA)	3
Road Closed To Through Traffic (RCT) Type III Barricade/ Staggered	2
Light Plants	2

2018 Willamette Country Music Festival

Marlatt Rd. and Talbot Intersection

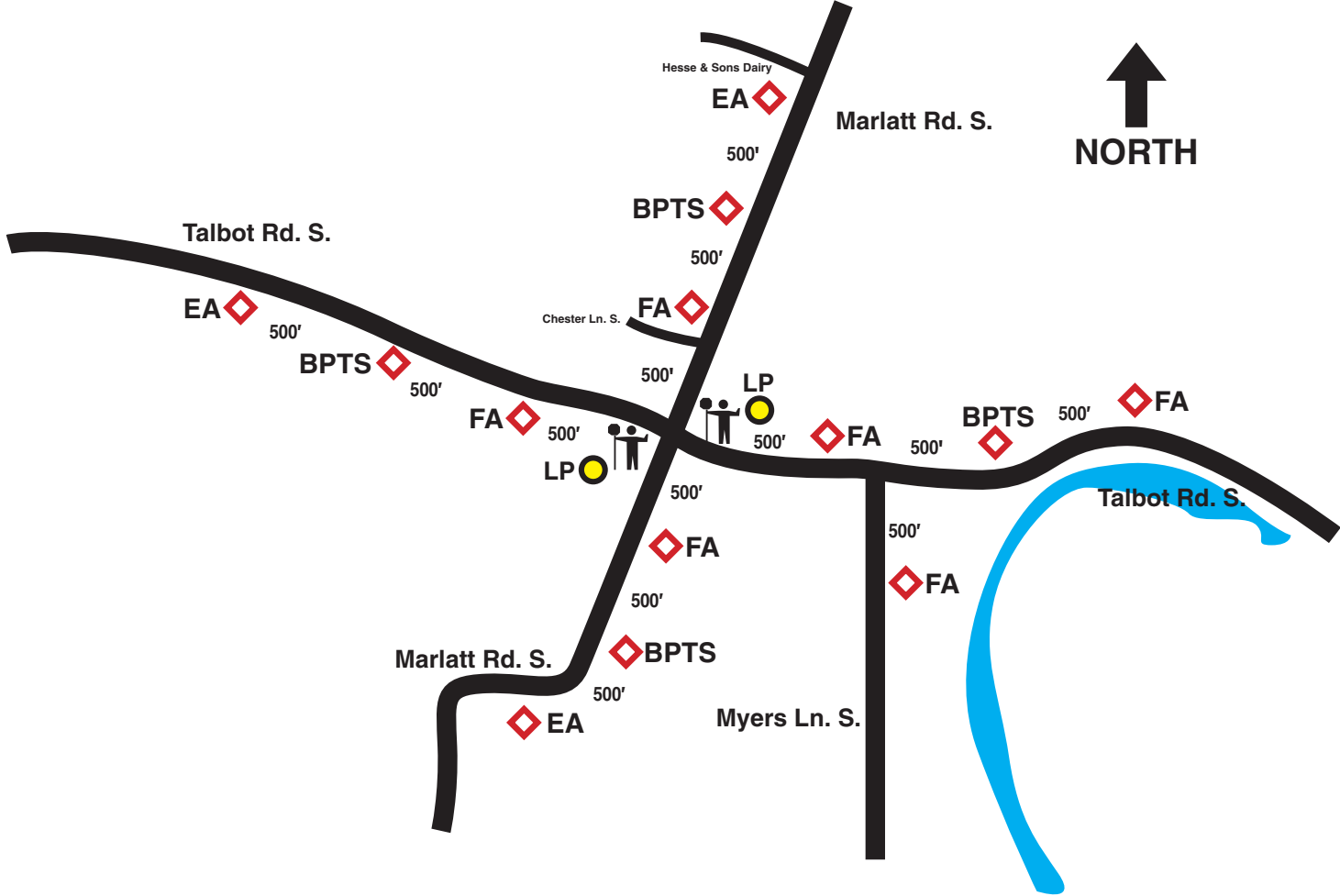

Flaggers will be on site approximately 10 am until the time traffic from the concert has ceased for the night. Flaggers will not flag unless traffic congestion requires it. If the flaggers need to flag contrary to, or through stop signs, the stop signs will be covered.

Light plants will be in place and on for each flagger. All times will be reviewed daily and changed accordingly.

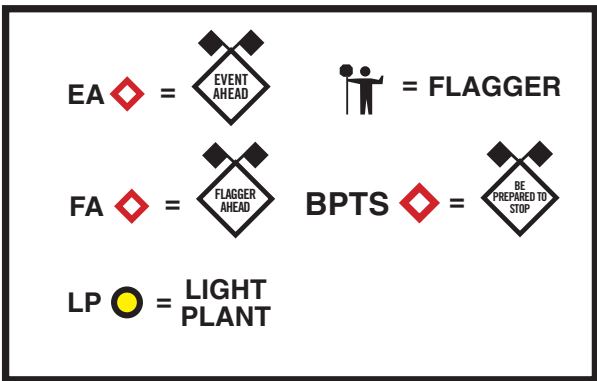

SIGN AND EQUIPMENT COUNT
Sign Spacing- 500'/ Sign Size- 36"

Event Ahead (EA)	5
Be Prepared to Stop (BPTS)	4
Flagger Ahead (FA)	4
Light Plants	2

2018 Willamette Country Music Festival

Marlatt Rd. and Wintel Intersection

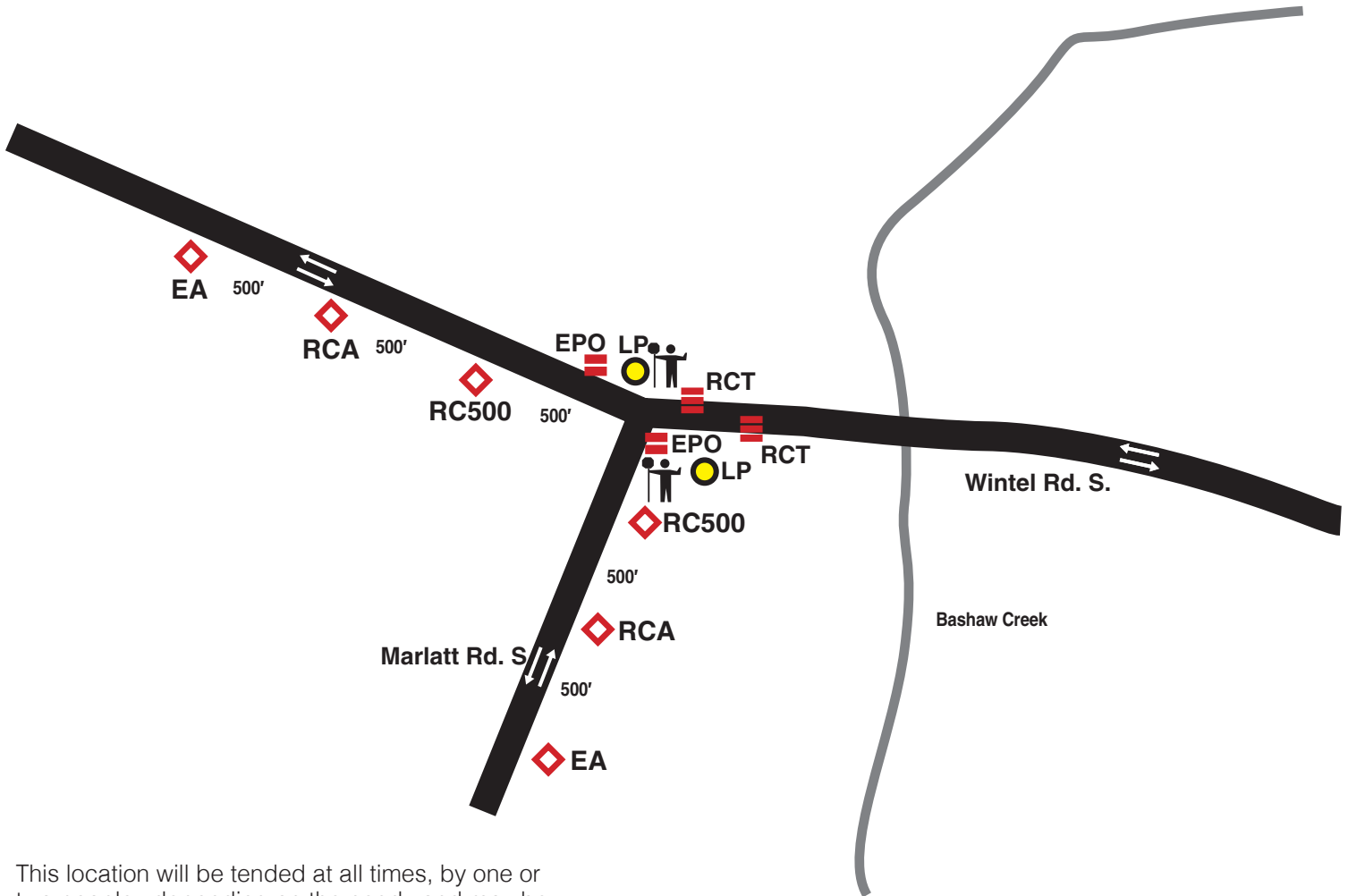

This location will be tended at all times, by one or two people– depending on the need– and may be removed completely at times if traffic flow dictates it, such as the end-of-night outflow traffic.

Illumination will be provided at night, although the intent is to let the signs guide traffic and not to actually “flag” at this location.

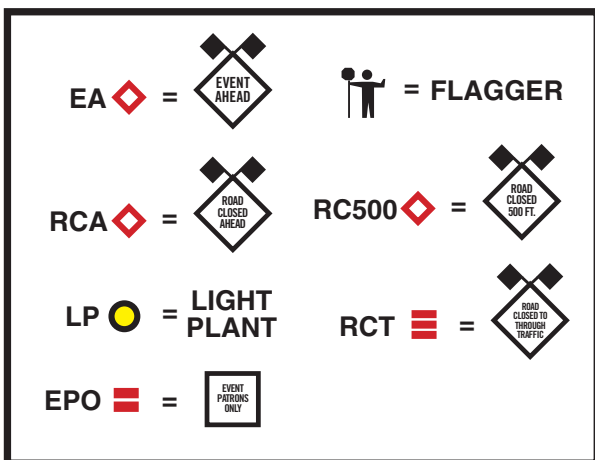

SIGN AND EQUIPMENT COUNT

Sign Spacing- 500'/ Sign Size- 36"

Event Ahead (EA)	2
Road Closed Ahead (RCA)	2
Road Closed-500' (RC500)	2
Road Closed To Through Traffic (RCT) Type III Barricade/ Staggered	2
Event Patrons Only (EPO) Type II Barricade	2
Light Plants	2

2018 Willamette Country Music Festival

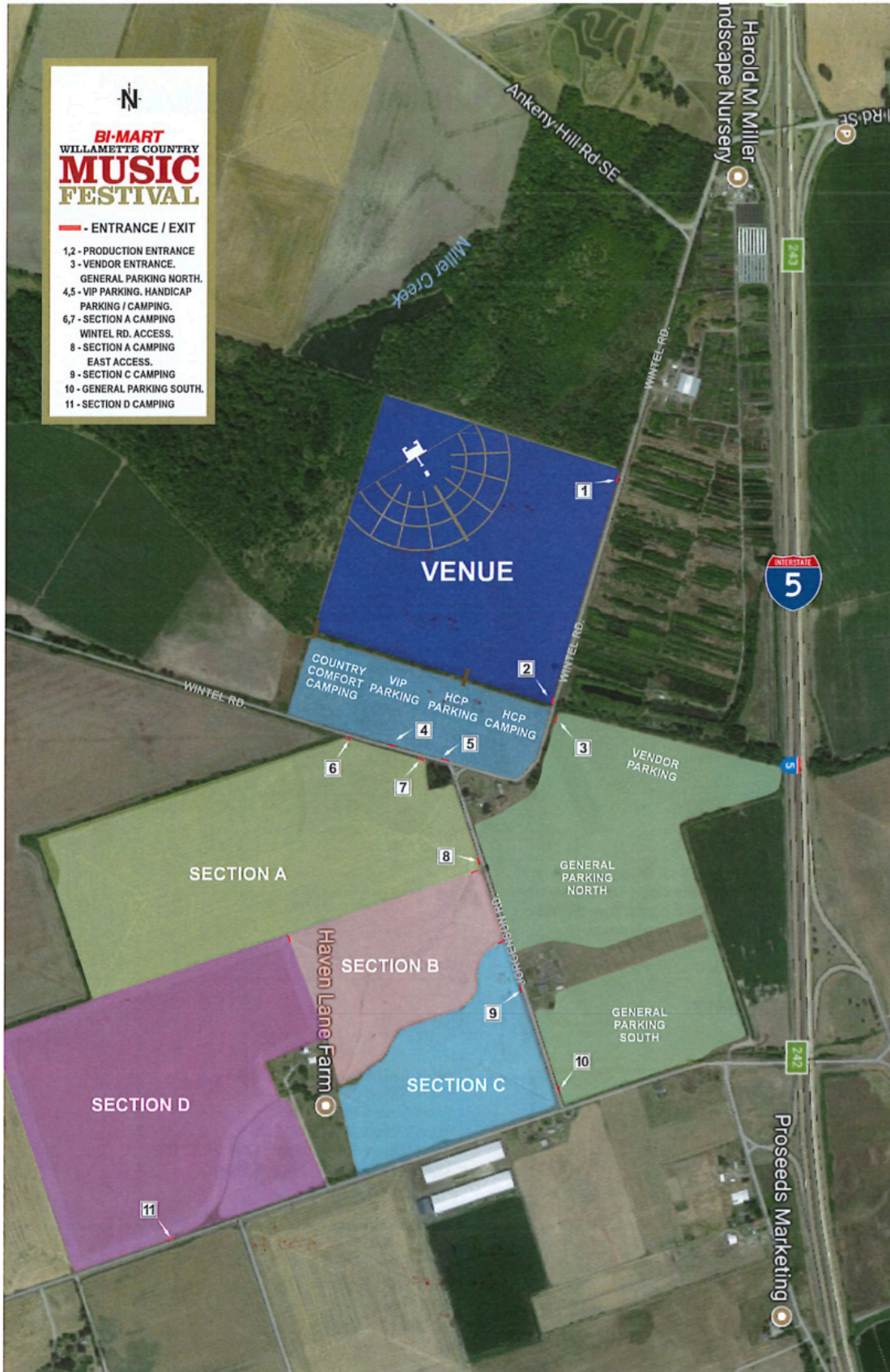

2018 Willamette Country Music Festival

Traffic Plan PCMS Signage

Prior to Event

A

E	V	E	N	T			
T	R	A	F	F	I	C	
A	U	G	1	6	-	1	9

B

E	X	P	E	C	T		
D	E	L	A	Y	S		

2018 Willamette Country Music Festival

Traffic Plan PCMS Signage

During the Event

1

	E	V	E	N	T		
T	R	A	F	F	I	C	
E	X	I	T		2	4	2

2018 Willamette Country Music Festival

Traffic Plan PCMS Signage

During the Event

2

E	V	E	N	T			
T	R	A	F	F	I	C	

3

U	S	E		E	X	I	T
2	4	2					
