

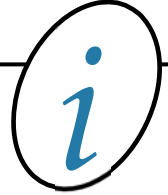

O R E G O N



Helpful Information from the Surveyor's Office

The Marion County Surveyor's Office is here to provide service to the public, and to licensed land surveyors. The documents you may receive from this office include surveys, maps, plats, or other pertinent data relating to the location, structures and facilities on property owned by you or other citizens. How you choose to use this information may directly affect you, your neighbors, or the public.

Did you know only persons licensed to practice land surveying by the Oregon State Board of Examiners for Engineering and Land Surveying can legally locate and establish boundaries? We strongly encourage citizens to seek assistance from a Professional Land Surveyor if they need to locate a survey monument, property line, building setback, easement, or other services related to making measurements, descriptions, reports, and maps pertaining to the physical features of and improvements on the earth. You can find local land surveyors listed in the yellow pages, or on the Professional Land Surveyors of Oregon (PLSO) web page.

Our goal is to help you be successful with your task and to provide you the documents filed in the Marion County Surveyor's Office.

Kent Inman
Marion County Surveyor



How to find a Survey Map

The following are steps to help you locate and view maps the county has on file.

1. Go to Marion County Oregon Surveyor's Office website by clicking on the following link:

<https://www.co.marion.or.us/PW/Survey> .

2. On the right hand column, under **Survey & Plat Research**, click on the [Internet Research Site](#) link, which will open up a Disclaimer page.

3. Read the Disclaimer and click the  button at the bottom of the page.

4. On the top blue bar, click on the three lines to the ***left of the Marion County Logo***, to show a drop down menu.



5. Click on **Survey Search** in the drop down menu.

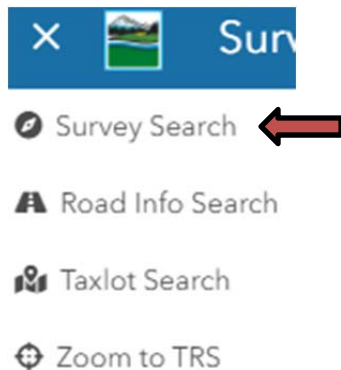



How to find a Survey Map

6. The **Search for Surveys** box will open on the right hand side. Here you can search for your property via Tax #, Tax Account, or Situs Address. Typically we suggest using Situs Address (the address of the property you are looking for information on). To do that, start to enter the address and it should start to auto populate like this:

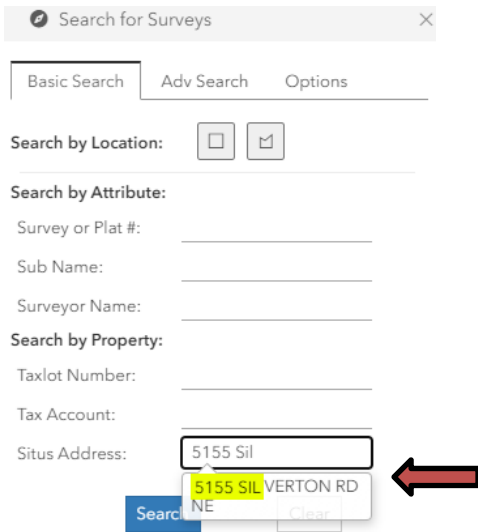



Click on the address and this will drill the map into your location and show any maps we have on record.

NOTE: Depending on your Internet Browser, you may get a pop-up window with links to maps, or you may get a pop-up blocked message. **See “Troubleshooting” section at end of these instructions**

7. To view more info on the maps associated with the above search type, on the bottom of the screen you will see a blue arrow pointing up,  click the blue arrow.

You will see several columns with different headings and a number of survey records associated with the property.

Image	Survey Num	Survey Date	Surveyor	Survey For	Type
	11234	1947-08-01	BATES	L D Egbert	Survey
	11313	1947-12-01	BATES	L D Egbert	Survey
	11847	1979-04-28	PAYNTER	Marion County	Survey
	11856	1979-04-11	PAYNTER	Marion County	Survey



How to find a Survey Map

It is important to keep in mind that not every record shown pertains to the property searched. You will have to do your own research, and we do not interpret maps for you. You may reach out to the Surveyor of record, or hire a Surveyor of your choice for further information.

8. You can sort data by clicking on the header. E.g. Click on **Survey Date** to sort by oldest to newest or vice versa or click on **Survey For** to sort names alphabetically.

This is the header

Image	Survey Num	Survey Date	Surveyor	Survey For	Type
	11234	1947-08-01	BATES	L D Egbert	Survey
	11313	1947-12-01	BATES	L D Egbert	Survey

9. Clicking on the survey # (E.g. ##### or P##-### or S##-###)

Image	Survey Num	Survey Date	Surveyor	Survey For	Type
	11234	1947-08-01	BATES	L D Egbert	Survey
	11313	1947-12-01	BATES	L D Egbert	Survey
	11847	1979-04-28	PAYNTER	Marion County	Survey
	11856	1979-04-11	PAYNTER	Marion County	Survey

This will highlight in blue, dots that resemble monuments used to point tag the general vicinity the survey took place. You may need to zoom out on the map to see which dots are being highlighted. This will help you sort which surveys you would like to look at for your research.





How to find a Survey Map

10. Once you choose a survey you want to view, click on the **Image** of a magnifying glass over a piece of paper, located just to the left of the survey number. This will open the map in a separate tab.



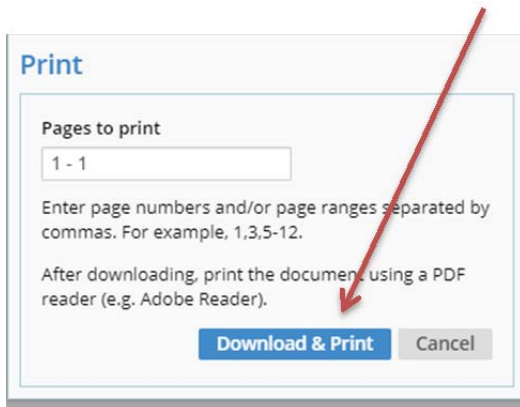

Image	Survey Num	Survey Date	Surveyor	Survey For	Type
	11234	1947-08-01	BATES	L D Egbert	Survey
	11313	1947-12-01	BATES	L D Egbert	Survey
	11847	1979-04-28	PAYNTER	Marion County	Survey
	11856	1979-04-11	PAYNTER	Marion County	Survey

11. If you would like to download the image for your records, in the tab the map opened up in you will see a printer icon with the words PDF next to it:  PDF click on it.

Click on the Download & Print option.



This will open the image in a PDF window. From there click "File" at the top of the screen which will give you a drop down menu.

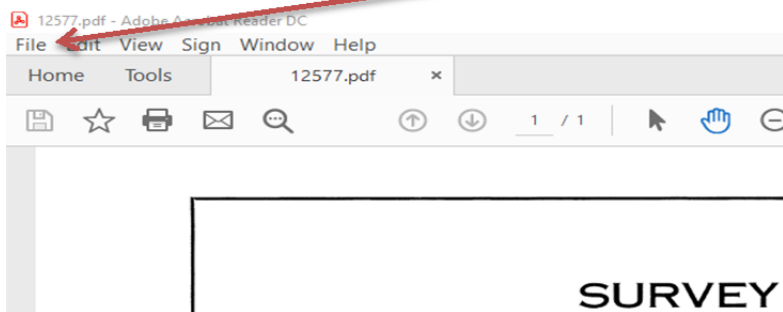



How to find a Survey Map

Next click "Save As".

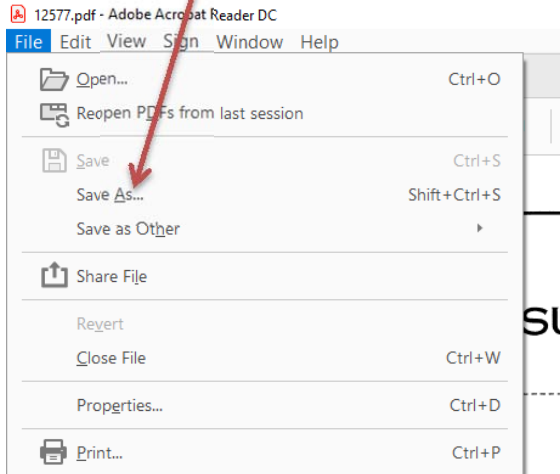

12. Select where you want the file saved and name the file.

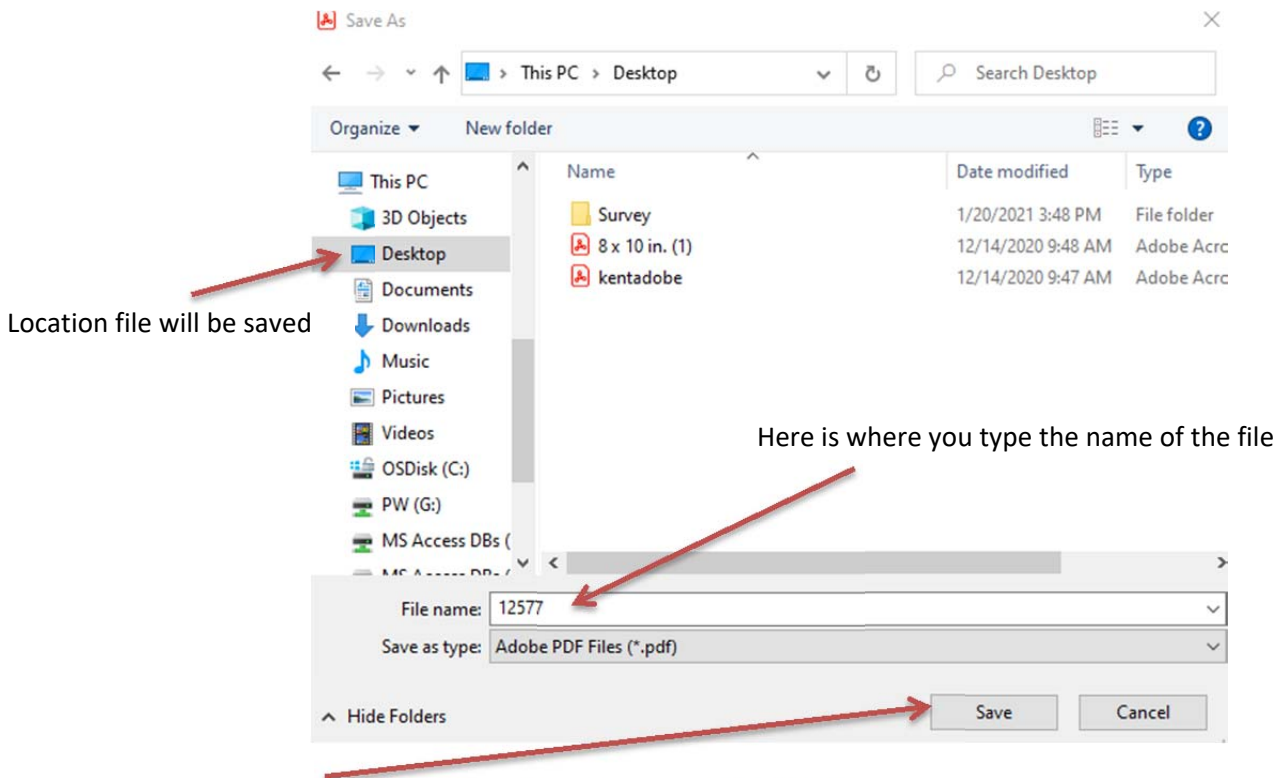

13. Click "Save" and now you have a copy of the file for your records to view.



How to find a Survey Map

Finding your Tax Lot Number and Tax Lot Map

When you pull up your property on the map (Step 6 in the previous directions) it should highlight your property on the map. Like this:

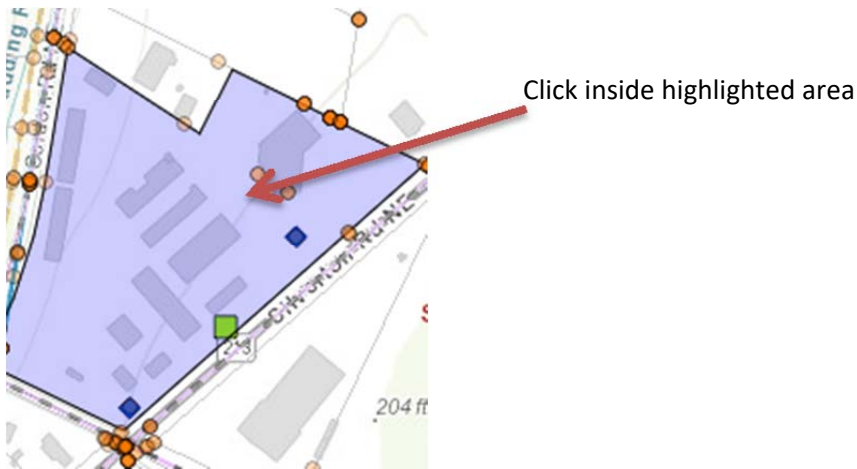

Click in the highlighted area and a window will pop up with information about your property including Tax Account, Taxlot Number, and Tax Map. Like this:

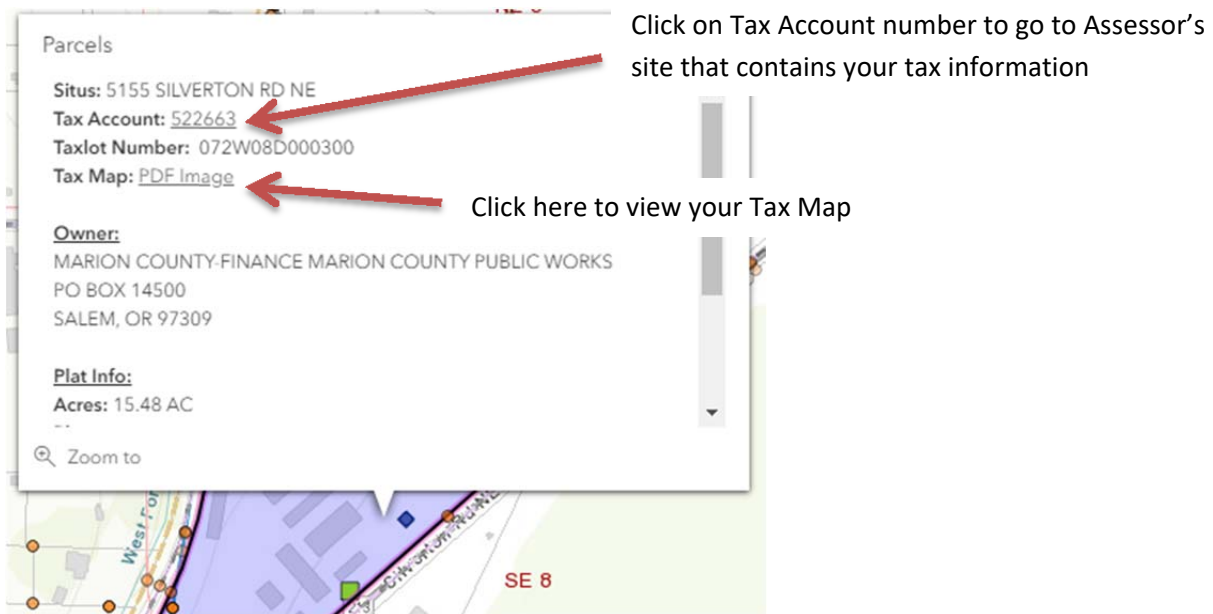



How to find a Survey Map

Clicking on the Tax Account number will take you to a screen on the Assessor's website that looks like this:

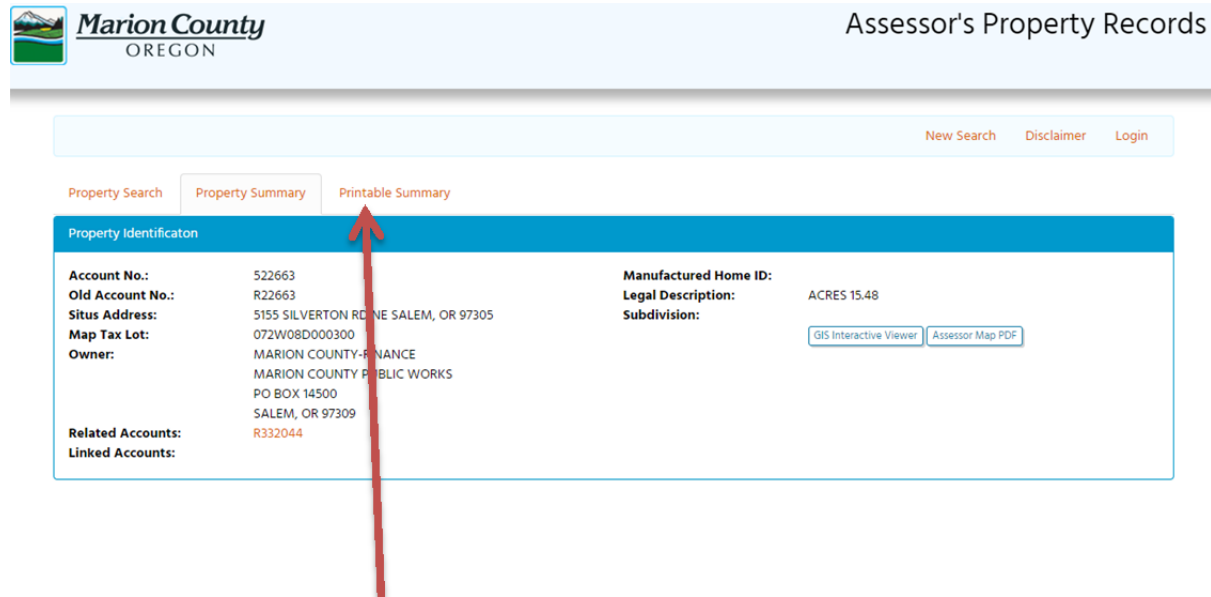

Clicking on the "Printable Summary" tab will open up another page with a list of information on that property including: Property Identification, Owner History, Property Details, Value Information, Assessment History, and Tax Information. Some deed information may be listed or shown. While we don't store that information at the Survey Office, you can use it to go to the Clerk's Office and research the deeds.



How to find a Survey Map

March 25, 2021

Property Identification

Old Account No.: R22663	Manufactured Home ID:
Account No.: 522663	Legal Description: ACRES 15.48
Situs Address: 5155 SILVERTON RD NE SALEM, OR 97305	Subdivision:
Map Tax Lot: 072W08D000300	
Owner: MARION COUNTY-FINANCE MARION COUNTY PUBLIC WORKS PO BOX 14500 SALEM, OR 97309	Related Accounts: R332044
	Linked Accounts:

Owner History

Buyer	Seller	Sales Info	Deed Info
MARION COUNTY	MARION COUNTY-FINANCE	06/07/2012 E33910398	E - EXCEPTION DEED WHERE PORTION SOLD OFF
			E08890463RD RD - REEL DEEDS RECORDED 1974 AND AFTER
			04950560 DE - MISCELLANEOUS DEEDS 1974 AND BEFORE
			08830334 RD - REEL DEEDS RECORDED 1974 AND AFTER

Property Details

Legal Acreage: 15.48 acres	Levy Code Area: 02400210
Property Code: Q30	Zoning: P (Contact Local Jurisdiction)
Property Class:	Miscellaneous Code:

(Example of Printable Summary page)



How to find a Survey Map

Additional Search Tools

There are 2 additional tools you can use to search for maps in a larger area.

1. Select "Survey Search" and then click on "AdvSearch" tab.

The screenshot shows a search interface titled "Search for Surveys" with a close button (X). Below the title are three tabs: "Basic Search", "Adv Search", and "Options". A red arrow points to the "Adv Search" tab. Underneath the tabs are several search categories with input fields:

- Search by Location:** Two square icons, one empty and one containing a map icon.
- Search by Attribute:** Three text input fields labeled "Survey or Plat #:", "Sub Name:", and "Surveyor Name:".
- Search by Property:** One text input field labeled "Taxlot Number:".

The box will now look like this:

The screenshot shows the same search interface, but now the "Adv Search" tab is selected and highlighted with a black border. The search categories have changed:

- Search by Location:** Two square icons, one empty and one containing a map icon.
- Search by Road:** One text input field labeled "Road Name:".
- Search by PLSS:** Three dropdown menus labeled "Township" (with "7S" selected), "Range" (with "1W" selected), and "Section" (which is currently empty).

At the bottom of the form are two buttons: a blue "Search" button and a white "Clear" button.

How to find a Survey Map

2. Select the Rectangle image or the Polygon image.

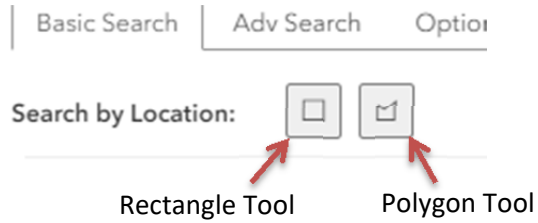

3. Draw a rectangle or polygon around the area you want to search.

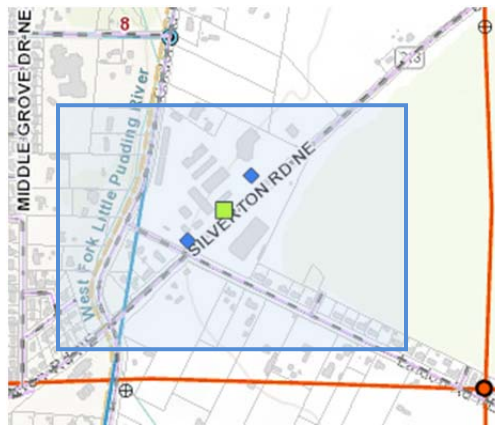

View using rectangle tool



View using polygon tool

NOTE – Double click to change the polygon tool back to a regular cursor

How to find a Survey Map

4. This will highlight dots that resemble monuments used to point tag the general vicinity the survey took place. It will create a list of maps we have on file for that entire area.

Before – no highlighted dots



After – highlighted dots

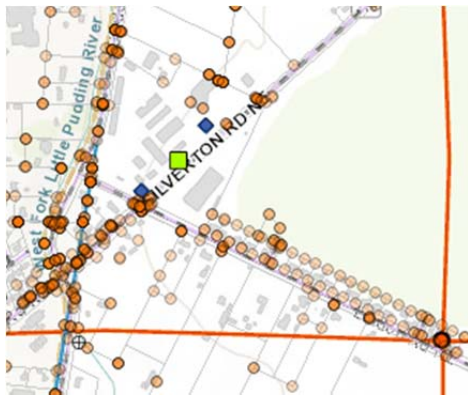

5. To view a particular map do the same steps as previously mentioned.



How to find a Survey Map

Troubleshooting:

Some Internet Browsers do not work well with our ISGI Maps. We suggest either Chrome or Edge.

If, when clicking on the map image, you get a Laserfiche error, close the tab and try clicking the map image again.

Some streets with apostrophes are not searchable. You may need to scroll into your area, or try searching a nearby street to drill down to your location.

Some Tax Account numbers create invalid search results. Try the Situs Address or Taxlot Number.

The surveys associated with a property search might not give you all the surveys relating to that property. If you do not get many results, try the more technical advanced search option below.

Getting more technical:

In the Search for Surveys box, you can use the Search by Location buttons to draw rectangles or polygons around properties and roads.

If looking for DLC's you can click the **Adv Search** tab in the Search for Surveys box. Select your Township, Range, and in Section type the DLC # (hint, DLC #'s are greater than 36). It will change Section to DLC.

Search for Surveys **Options** tab allows you to select specific data to show/hide.

The gear image in the top blue bar allows you to select specific maps to show/hide.

NOTICE

The Marion County Surveyor's Office is the **LIBRARY** of public record survey maps in Marion County. We can guide you to the maps, but we do not interpret the maps for you. If you need someone to interpret the map, please contact the Surveyor of record, or a Surveyor of your choice.

We hope you find this guide helpful. If you have further questions or need further assistance, please call us at: **503-588-5155**.